



Joint Conference for RC06 (Family) & RC41 (Population)

# Changing Demography ↔ Changing Families

Singapore | 17-19 May 2018

## PROGRAMME



Organised by:

Sponsored by:



Centre for Family and Population Research (CFPR)  
Department of Sociology  
Faculty of Arts and Social Sciences  
Global Asia Institute

OUE

## KEYNOTE SPEAKER



### Professor Judith Seltzer

Department of Sociology, University of California,  
Los Angeles (UCLA)

2016 President, Population Association of America

Director, UCLA California Center for Population Research

### **Family and Demographic Change: Problems and Progress**

Judith A. Seltzer is professor of sociology and director of the California Center for Population Research at the University of California, Los Angeles. Previously, she was on the faculty of the University of Wisconsin–Madison, where she contributed to the development and implementation of the U.S. National Survey of Families and Households. Her research interests include kinship patterns, intergenerational obligations, relationships between nonresident fathers and children, and how legal institutions and other policies affect family change.

She is especially interested in kinship institutions that are in flux, such as marriage and cohabitation in the contemporary United States or divorced, non-marital, and step families. She also explores ways to improve the quality of survey data on families, and in 2013 Seltzer and her colleagues added a module with family rosters to the Panel Study of Income Dynamics to provide new data on U.S. family networks.

She currently serves on the Committee on National Statistics (CNSTAT) of the U.S. National Academies of Sciences (NAS). Previously she served on the CNSTAT Standing Committee on Reengineering Census Operations, and several NAS panels on the census. She was president of the Population Association of America in 2016. She has a B.A. in sociology from Princeton University and both an M.A. and Ph.D. in sociology from the University of Michigan.

## KEYNOTE SPEAKER



### Professor Wolfgang Lutz

Founding Director, Wittgenstein Centre for Demography and Global Human Capital

Director, World Population Program, International Institute for Applied Systems Analysis (IIASA)

Director, Vienna Institute of Demography

Professor for Social and Economic Statistics,  
Vienna University of Economics and Business

### Population and Climate Change

Wolfgang Lutz is Founding Director of the Wittgenstein Centre for Demography and Global Human Capital, a cooperation between IIASA (where he directs the World Population Program), the Austrian Academy of Sciences (where he is scientific director of the Vienna Institute of Demography), and the Vienna University of Economics and Business (where he is Professor of Applied Statistics). He holds a PhD in Demography from the University of Pennsylvania.

He has widely published on international population trends with a special focus on population forecasting, population-development-environment interactions and introducing education as a standard demographic dimension in addition to age and sex. He has published over 250 scientific articles, including 11 in *Science and Nature*. His most recent book with OUP is entitled “World Population and Human Capital in the 21st Century”. He has won prestigious awards including the Wittgenstein Prize, two ERC Advanced Grants, the Mattei Dogan award of the IUSSP and the Mindel Shaps Award of PAA. He is member of the Austrian Academy of Sciences, the Leopoldina, the World Academy of Sciences (TWAS), the Finnish Society for Sciences and Letters, and the US National Academy of Sciences (NAS).

Professor Lutz has been appointed by the UN Secretary-General to be one of the 15 members of the Independent Group of Scientists whose task is to produce the quadrennial Global Sustainable Development Report 2019.

MANDARIN ORCHARD SINGAPORE  
BALLROOMS 1 & 2  
MAIN TOWER, LEVEL 6

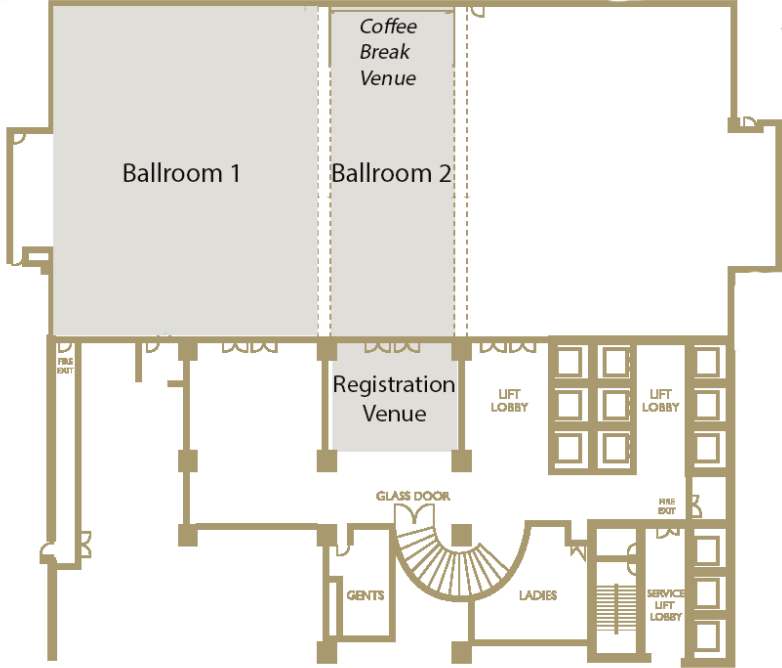

MANDARIN ORCHARD SINGAPORE  
MEETING SUITES 801 - 805  
MAIN TOWER, LEVEL 8

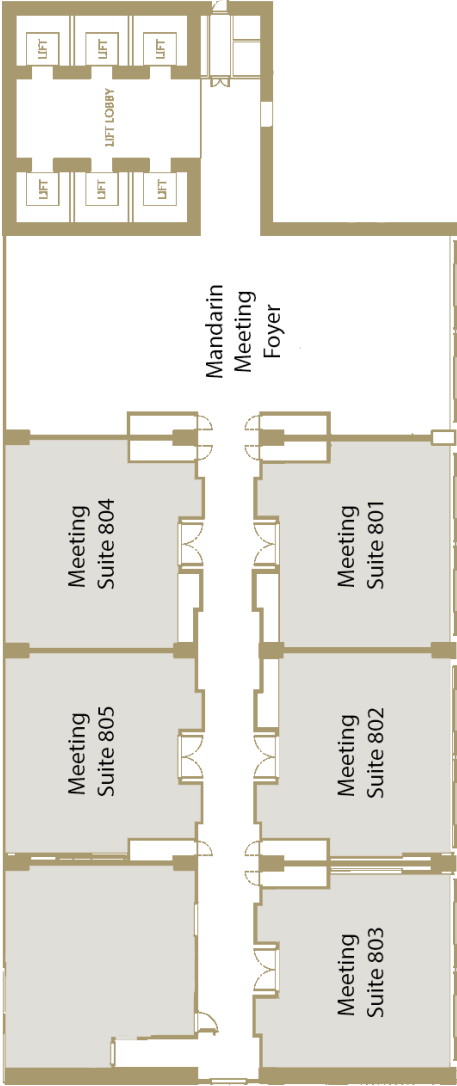

MANDARIN ORCHARD SINGAPORE  
MEETING SUITE ROOM 607  
ORCHARD WING, LEVEL 6

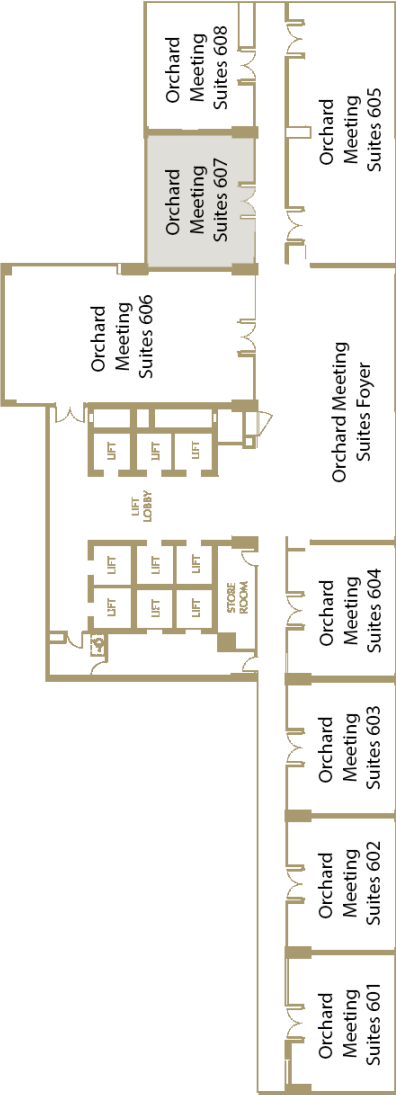

## PROGRAMME COMMITTEE

Wei-Jun Jean Yeung (NUS) (Committee Chair)

Lavanya Balachandran (NUS)

Ly Phan (NTU)

Angelique Chan (NUS)

Stella Quah (NUS)

Vincent Chua (NUS)

Joonmo Son (NUS)

Premchand Dommaraju (NTU)

Sun Hsiao-Li Shirley (NTU)

Feng Qiushi (NUS)

Tan Ern Ser (NUS)

Gu Xiaorong (NUS)

Tan Joo Ean (NTU)

Hu Shu (NUS)

Tan Poh Lin (NUS)

Erin Kim Hye-Won (NUS)

Bussarawan Puk Teerawichitchainan  
(SMU)

Ko Pei-Chun (NUS)

Thang Leng Leng (NUS)

Yvaine Koh Yee Woen (NUS)

Kriti Vikram (NUS)

Yeonjin Lee (NUS)

Xiao Hong (NTU)

Liu Haoming (NUS)

Yi Junjian (NUS)

Maznah Mohamad (NUS)

Yang Yi (NUS)

Mu Zheng (NUS)

## CONFERENCE SECRETARIAT

Pasaraba Lori Jane Masil (CFPR, NUS)

Nawal Binti Mohamed Hashim (CFPR, NUS)

Zuraihah Binte Mohamad (CFPR, NUS)

Sascha Ng (CFPR, NUS)

Sumaiya Rahman (CFPR, NUS)

Joyous Tan (CFPR, NUS)

# ORGANIZERS

## Main Organizer



Centre for Family and Population Research  
Faculty of Arts & Social Sciences

## Co-organizers



NUS Global  
Asia Institute



Department of Sociology  
Faculty of Arts & Social Sciences

## Sponsors

OUE



Faculty of Arts  
& Social Sciences

## Exhibitors



## Supported by

## Held in





# PROGRAMME OUTLINE

**Thursday, 17 May 2018 (Day 1)**

*\*Venue will be in Main Tower of Mandarin Orchard Singapore unless specified otherwise*

Time	Details	Venue
08.00 - 08.40	<i>Registration / Coffee and Tea</i>	<i>L6, Ballroom Foyer</i>
08:40 - 09.00	<p><b>Opening and Welcome by Host Institution</b></p> <p>Professor Wei-Jun Jean Yeung            Director, Centre for Family and Population Research            Provost's Chair Professor, Department of Sociology            Research Leader, Asia Research Institute,            Faculty of Arts and Social Sciences,            National University of Singapore</p> <p>Professor Noah Lim,            Director, Global Asia Institute,            National University of Singapore</p> <p>Welcome from RC06 President,            Professor Yi Chin-Chun, Academia Sinica</p> <p>Welcome from RC41 Representative,            Professor Emeritus Ofra Anson,            Ben-Gurion University of the Negev</p>	<i>L6, Ballroom 1</i>
09.00 - 09.40	<p><b>Keynote Speech by Professor Judith Seltzer</b>  <b>Family and Demographic Change: Problems and Progress</b></p> <p>Department of Sociology, University of California, Los Angeles (UCLA)            2016 President, Population Association of America            Director, UCLA California Center for Population Research</p>	<i>L6, Ballroom 1</i>
09.40 – 10.00	<b>Coffee Break</b>	<i>L6, Ballroom 2</i>
10.00 – 11.20	<p><b>Parallel sessions</b></p> <p>1.1 Global Family Change</p>	<i>L6, Ballroom 1</i>

	1.2 Agency, Cohorts and Life Course	<i>L8, Meeting Suites 801</i>
	1.3 Society, Family, and Female Labor Force Participation	<i>Orchard Wing - L6, Meeting Suite 607</i>
	1.4 Family Structure and Wellbeing	<i>803</i>
	1.5 Wellbeing of Migrants	<i>804</i>
	1.6 Sexuality and Reproductive Health (I)	<i>805</i>
	1.7 Singapore Family & Population Changes: Book Launch (I)	<i>802</i>
<b>11.20 - 11.30</b>	<b><i>Moving to break-out rooms</i></b>	
<b>11.30 - 12.50</b>	<b>Parallel sessions</b>	
	2.1 Social Capital: Diverse Causes and Externalities	<i>L6, Ballroom 1</i>
	2.2 Poverty and Inequality	<i>L8, Meeting Suites 801</i>
	2.3 Fertility and Public Policy	<i>Orchard Wing - L6, Meeting Suite 607</i>
	2.4 Migration and Gender	<i>803</i>
	2.5 Labor Force	<i>804</i>
	2.6 Health, Wellbeing and Aging	<i>805</i>
	2.7 Singapore Family & Population Changes: Book Launch (II)	<i>802</i>
<b>12.50 - 13.50</b>	<b>Lunch</b>	<i>L6, Ballroom 2</i>
<b>13.50 - 15.10</b>	<b>Parallel sessions</b>	
	3.1 Longitudinal Surveys on Family	<i>L6, Ballroom 1</i>
	3.2 Migration and Child Wellbeing	<i>L8, Meeting Suites 801</i>
	3.3 Fertility Trends and Family	<i>802</i>
	3.4 Marriage in Transition	<i>803</i>
	3.5 Migration Perspectives	<i>804</i>
	3.6 Transition to Adulthood (I)	<i>805</i>
<b>15.10 - 15.40</b>	<b><i>Coffee Break</i></b>	<i>L6, Ballroom 2</i>
<b>15.40 - 17.00</b>	<b>Parallel sessions</b>	
	4.1 Marriage Markets	<i>L6, Ballroom 1</i>
	4.2 Education (I)	<i>L8, Meeting Suites 801</i>

	4.3 Sex Preference and Gender Issues	802
	4.4 Social Engagement and Caregiving in Older Age	803
	4.5 Ethnic Minorities in Asia-Pacific	804
	4.6 Transition to Adulthood (II)	805
<b>19.00</b>	<b>Conference Dinner</b>	<i>L6, Ballroom 1</i>

## Friday, 18 May 2018 (Day 2)

*\*Venue will be in Main Tower of Mandarin Orchard Singapore unless specified otherwise*

<b>Time</b>	<b>Details</b>	<b>Venue</b>
<b>08.00 - 08.35</b>	<i>Registration / Coffee and Tea</i>	<i>L6, Ballroom Foyer</i>
<b>08.35 - 09.15</b>	<b>Keynote Speech by Professor Wolfgang Lutz</b> <b>Population and Climate Change</b> Founding Director, Wittgenstein Centre for Demography and Global Human Capital Director, World Population Program, International Institute for Applied Systems Analysis (IIASA) Director, Vienna Institute of Demography Professor for Social and Economic Statistics, Vienna University of Economics and Business	<i>L6, Ballroom 1</i>
<b>09.15 – 09.45</b>	<b><i>Coffee Break</i></b>	<i>L6, Ballroom 2</i>
<b>09.45 – 11.05</b>	<b>Parallel sessions</b>	
	5.1 Changing Family Structures, Caregiving and Family Support in Later Life	<i>L6, Ballroom 1</i>
	5.2 Child Care and Family Dynamics	<i>L8, Meeting Suites 801</i>
	5.3 Work, Family Relations, and Public Policy	<i>802</i>
	5.4 Migration and Development	<i>803</i>
	5.5 Non-normative Families (I)	<i>804</i>
	5.6 Transition to Adulthood (III)	<i>805</i>
<b>11.05 – 11.15</b>	<b><i>Moving to break-out rooms</i></b>	
<b>11.15 – 12.35</b>	<b>Parallel sessions</b>	

	6.1 Women's Employment and Family Life in Asia	<i>L6, Ballroom 1</i>
	6.2 Union Dissolution and Remarriage (I)	<i>L8, Meeting Suites 801</i>
	6.3 Physical Functions and Cognitive Function in Later Life	<i>802</i>
	6.4 Marriage Trends (I)	<i>803</i>
	6.5 Non-normative Families (II)	<i>804</i>
	6.6 New Dynamics and New Data for Families in Shanghai	<i>805</i>
<b>12.35 - 13.35</b>	<b>Lunch</b>	<i>L6, Ballroom 2</i>
<b>13.35 - 14.55</b>	<b>Parallel sessions</b>	
	7.1 Population Dynamics and Forecasts	<i>L6, Ballroom 1</i>
	7.2 Education (II)	<i>L8, Meeting Suites 801</i>
	7.3 Family Life and Inequality	<i>802</i>
	7.4 Union Dissolution and Remarriage (II)	<i>803</i>
	7.5 Coping with Retirement	<i>804</i>
	7.6 State, Family & Population (I)	<i>805</i>
<b>14.55 – 15.25</b>	<b>Coffee Break</b>	<i>L6, Ballroom 2</i>
	<b>Meet the Editors Session for Asian Population Studies</b>	<i>Routledge Booth</i>
<b>15.25 – 16.40</b>	<b>Parallel sessions</b>	
	8.1 Child Care and Child Development	<i>L6, Ballroom 1</i>
	8.2 Intergenerational Dynamics	<i>L8, Meeting Suites 801</i>
	8.3 Health and Family	<i>802</i>
	8.4 Marriage Trends (II)	<i>803</i>
	8.5 Aging and Beyond	<i>804</i>
	8.6 Data and Methods	<i>805</i>
	<b>End of Day 2</b>	

## Saturday, 19 May 2018 (Day 3)

*\*Venue will be in Main Tower of Mandarin Orchard Singapore unless specified otherwise*

<b>Time</b>	<b>Details</b>	<b>Venue</b>
<b>07.45 - 08.30</b>	<i>Registration / Coffee and Tea</i>	<i>L6, Ballroom Foyer</i>
<b>08.30 - 09.50</b>	<b>Parallel sessions</b>	
	9.1 Time Use and Quality of Life	<i>L6, Ballroom 1</i>
	9.2 Gender and Child Development	<i>L8, Meeting Suites 801</i>
	9.3 Historical Demography	<i>802</i>
	9.4 Marriage and Family Life	<i>803</i>
	9.5 Sexuality and Reproductive Health (II)	<i>804</i>
	9.6 State, Family and Population (II)	<i>805</i>
<b>09.50 – 10.20</b>	<b><i>Coffee Break</i></b>	<i>L6, Ballroom 2</i>
<b>10.20 – 12.00</b>	<b>Plenary Session on Family Changes in Asia</b> <b>Keynote Speakers:</b> Professor Emeritus Ofra Anson, <i>Ben-Gurion University of the Negev</i> Professor Gavin Jones, <i>Australian National University</i> Professor Wei-Jun Jean Yeung, <i>National University of Singapore</i>	<i>L6, Ballroom 1</i>
<b>12.00 – 12.30</b>	<b>Farewell Tea &amp; Closing of the Conference</b>	<i>L6, Ballroom 1</i>

# PANEL SESSIONS

**Day 1: Thursday, 17 May 2018**

Parallel Sessions: 10.00 - 11.20		
Session Title	Paper Title	Authors
<b>1.1 Global Family Change</b>	<a href="#">Global Family Change: The Reshaping of Society's Most Fundamental Institution with Development</a>	Frank Furstenberg
Session Chair: <a href="#">Gavin Jones</a>	<a href="#">Household Composition in Indian States: Emerging Patterns and Implications</a>	Sruthi Anilkumar Hemalatha, Nelson Franklin Soy
Venue: L6, Ballroom 1	<a href="#">Single-person Households in Seoul and Implication for Family Policies</a>	Young Jeong Kim, Jinhee Jang
	<a href="#">Is It the Shape or the Substance? Family Structure, Family Environment and Early Drinking: Evidences from the UK Millennium Cohort Study</a>	Marta Pasqualini, Donatella Lanari, Luca Pieroni
<b>1.2 Agency, Cohorts and Life Course</b>	<a href="#">Twenty-One Years of Health and Nutrition Transitions of Older Adults: Evidence from Indonesia</a>	John Strauss, Firman Witoelar, Bondan Sikoki
Session Chair: <a href="#">Li-Hui Lin</a>	<a href="#">Gender Role Attitudes in Japan: Age, Period, and Cohort Analysis</a>	Martin Piotrowski, Akiko Yoshida, Lauren Johnson, Rick Wolford
Venue: L8, Meeting Suite 801	<a href="#">Cohort Change at the Intersection of Gender and Ethnicity: The Case of Mobility Limitations among Older Adults in Singapore</a>	Shannon Ang
	<a href="#">Aging Couples: Successful Aging and the Limits of Autonomy and Agency in the Dyadic Life Course</a>	Markus Klingel
<b>1.3 Society, Family, and Female Labor Force Participation</b>	<a href="#">Mothering in the Australian Defence Force (ADF) 'Family'</a>	Kate Huppertz, Selda Dagistanli
Session Chair: <a href="#">Junko Nishimura</a>	<a href="#">Family Responsibilities versus Values: Why Korean Women Choose to Work</a>	Ji Hye Kim, Mary Noonan

Venue: Orchard Wing - L6, Meeting Suite 607	<a href="#">Effects of Young Adults' Employment Type on their Desire to Get Married or Cohabit: A Comparative Analysis of Six Countries in Asia and Europe</a>	Shigeki Matsuda
<b>1.4 Family Structure and Wellbeing</b>	<a href="#">Migration Arrangements of Couples, Satisfaction with Spousal Contributions, and Perception of Happiness of Rural Chinese</a>	Jenny Xin Li, Yuying Tong, Binbin Shu
Session Chair: <a href="#">Adam Ka-Lok Cheung</a>	<a href="#">Marital Satisfaction and Wellbeing among Older Korean Couples</a>	Pei-Chun Ko, Yeonjin Lee
Venue: L8, Meeting Suite 803	<a href="#">Model of Relations of Husband-Wife of Public Workers on the Family Long Distance Marriage</a>	Antari Ayuning Arsi, Fajar Ajang, Harto Wicaksono
	<a href="#">Marital Satisfaction of Separate Sleepers</a>	Christine Danne Dato, Constantino Narciso Sanchez
<b>1.5 Wellbeing of Migrants</b>	<a href="#">Psychological Well-being of Rural Migrant Workers in China: A Longitudinal Analysis Based on Latent Growth Curve Model</a>	Sizhe Liu, Qiang Ren, Wei Zhang
Session Chair: <a href="#">Sara Curran</a>	<a href="#">The Paradox of Subjective Social Status of Migrants in China</a>	Qiong Wu, Chunni Zhang, Peng Huang
Venue: L8, Meeting Suite 804	<a href="#">Bagong Bayani (New Heroes): The Lived Experiences of Filipino Domestic Helpers</a>	Jhun Himoldang
	<a href="#">Slavery at Brick Kilns: A Study of Distressed Seasonal Migration to Brick Kilns in India</a>	Bibhishana Bhuyan, Kailash Chandra Das
<b>1.6 Sexuality and Reproductive Health (I)</b>	<a href="#">Conflict and Contraception in Colombia</a>	Signe Svalfors, Sunnee Billingsley
Session Chair: <a href="#">Farhat Yusuf</a>	<a href="#">How Much do They Know? An Analysis of the Accuracy of HIV Knowledge Among Youth Affected by the Disease in South Africa</a>	Nicole De Wet, Joshua Akinyemi, Clifford Odimegwu
Venue: L8, Meeting Suite 805	<a href="#">Tamil University Students' Attitudes Regarding Sexually Transmitted Infections: A Case Study Based on University of Colombo</a>	Migara Karunarathne

	<a href="#">What is the Association between IPV and Fertility in Uganda?</a>	Sasha Frade, Clifford Odimegwu
<b>1.7 Singapore Family Population &amp; Changes: Book Launch (I)</b>	<a href="#">Family and Population Changes in Singapore: A Unique Case in the Global Family Change</a> Chair: Charles Hirschman Commentators: Yi Chin-Chun, Judith Seltzer <i>Venue: L8, Meeting Suite 802</i>	Wei-Jun Jean Yeung, Shu Hu, Routledge
<b>Parallel Sessions: 11.30 - 12.50</b>		
<b>Session Title</b>	<b>Paper Title</b>	<b>Authors</b>
<b>2.1 Social Capital: Diverse Causes and Externalities</b>  Session Chair: <a href="#">Joonmo Son</a>  Venue: L6, Ballroom 1	<a href="#">The Unequal Labour Market Profits for Ethnic Social Capitals</a>	Bonnie H. Erickson
	<a href="#">Network Diversity and the Link to National Identity and Social Cohesion</a>	Vincent Chua, Ern Ser Tan, Gillian Koh
	<a href="#">The Role of the Partner's Sociodemographic Background in the Integration Process of Roma University Students</a>	Beata David, Agnes Lukács
	<a href="#">The El-Nino-induced Disaster and the Loss of Social Capital: Evidences from Two Communities in Vietnam</a>	Trung Kien Nguyen
<b>2.2 Poverty and Inequality</b>  Session Chair: <a href="#">Anja Steinbach</a>  Venue: L8, Meeting Suite 801	<a href="#">Dynamics of Asset Poverty in South Korea, 2005 to 2014</a>	Soyoon Weon, David Rothwell
	<a href="#">Patterns of Childhood Economic Hardship and Early Adulthood Obstacles</a>	Miia Bask, Tiina Ristikari, Pasi Haapakorva, Mika Gissler
	<a href="#">The Determinants of Poverty in Sudan</a>	Awatif Musa
	<a href="#">Poverty, Ecological Vulnerability and Strategy of Women in Coastal Area to Alleviate from Poverty: Learning from Bedono Village, Central Java, Indonesia</a>	Asma Luthfi
<b>2.3 Fertility and Public Policy</b>	<a href="#">Generational Difference in Women's Fertility Intentions under China's Two-Child Policy</a>	Yingchun Ji, Huiguang Wang, Yue Liu, Ruonan Xu



Session Chair: <a href="#">Erin Hye-Won Kim</a>	<a href="#">What can We Learn from the Public Sector in Germany Regarding Fertility? Is it Really the Workplace or Just Selection?</a>	Paul Severin Löwe, Michael Gebel
Venue: Orchard Wing - L6, Meeting Suite 607	<a href="#">Fertility Transition in Qatar: A Challenge to be Met or an Achievement to be Sustained?</a>	Abdel-Samad M. Ali
	<a href="#">Influence of Maternal Age and Occupation on Pregnancy Outcomes in Japan</a>	Yukiko Senda
<b>2.4 Migration and Gender</b>	<a href="#">Father's Migration and Cognitive Achievement Among Left Behind Children in India: A Gendered Story</a>	Kriti Vikram
Session Chair: <a href="#">Zhenzhen Zheng</a>	<a href="#">Migration and the Family Division of Housework in China: Evidence from Tied Movers</a>	Jing Song, Weiwen Lai
Venue: L8, Meeting Suite 803	<a href="#">Migration, Health, and Mortality in Rural Africa: A Longitudinal Analysis</a>	Victor Agadjanian, Sarah Hayford, Natalie Jansen
	<a href="#">Reconsidering the Role of the Same-gender Parent: Impacts of Parental Migration and Parental Emotional Support on Life Satisfaction of Adolescent Boys and Girls</a>	Binbin Shu
<b>2.5 Labor Force</b>	<a href="#">Youth Unemployment among Immigrants of Different Religions in Canada</a>	Eric Fong, Kumiko Shibuya
Session Chair: <a href="#">Michael Gebel</a>	<a href="#">A Study on NEET (Not in Education, Employment, or Training) Young Adults in China Findings from the CLDS</a>	Yi Yang
Venue: L8, Meeting Suite 804	<a href="#">Female Employment in India: What Determines the Choice of Sector of Activity</a>	Sandhya Mahapatro
<b>2.6 Health, Wellbeing and Aging</b>	<a href="#">Psychological Resilience among Midlife Singaporeans: Extent and Correlates</a>	Angelique Chan, Abhijit Visaria, June May-Ling Lee, Rahul Malhotra
Session Chair: <a href="#">Susan McDaniel</a>	<a href="#">Social Engagement, Gender, and the Cognitive Trajectories of Older South Koreans: An Application of the Growth Mixture Model</a>	Yeonjin Lee, Jean Wei-Jun Yeung

Venue: L8, Meeting Suite 805	<a href="#">Prevalence and Factors Associated with Common Mental Disorders among Older Persons in Indonesia: A Cross Sectional Survey</a>	Evi Nurvidya Arifin, Syarifah Nuraini
	<a href="#">Eventually Everything Runs Out: Becoming Homeless in Singapore</a>	Harry Tan
<b>2.7 Singapore Family Population &amp; Changes: Book Launch (II)</b>	<a href="#">Dual-income Households among Singapore Malay Families: Changing Economy, Unchanging Gender Roles</a>	Suriani Suratman, Maznah Mohamad
	<a href="#">‘Indians’ under Official Multiracialism in Singapore: Unpacking Heterogeneity</a>	Lavanya Balachandran
Venue: L8, Meeting Suite 802	<a href="#">Falling Short: Class and the Performance of the Familial</a>	You Yenn Teo
	<a href="#">Singapore’s Approach to Ageing Policies: Tacking the Limits of the Family in Supporting Seniors</a>	Leng Leng Thang, Johan Suen
<b>Parallel Sessions: 13.50 - 15.10</b>		
<b>Session Title</b>	<b>Paper Title</b>	<b>Authors</b>
<b>3.1 Longitudinal Surveys on Family</b>	<a href="#">50 Years of the Panel Study on Income Dynamics (PSID)</a>	Narayan Sastry
Session Chair: <a href="#">Frank Furstenberg</a>	<a href="#">An Authoritative Survey Project on Chinese Family and Society: China Family Panel Studies (CFPS)</a>	Tao Kong, Hua Ding
Venue: L6, Ballroom 1		
<b>3.2 Migration and Child Wellbeing</b>	<a href="#">Impacts of Migration on Children Left Behind in Myanmar: Evidence from a Recent Survey in Myanmar's Dry Zone</a>	Bussarawan Teerawichitchainan, John Knodel
Session Chair: <a href="#">Janeen Baxter</a>	<a href="#">The Coming Generations: Transnational Childrearing Experiences and Family Envisioning among Chinese Families</a>	Laura Lamas Abraira
Venue: L8, Meeting Suite 801	<a href="#">Acculturation and Academic Achievement of Rural to Urban Migrant Youth: The Role of Perceived Social Support and School Satisfaction</a>	Lue Fang

	<a href="#">Migration and Young Children's Cognitive Development in China</a>	Xuejiao Chen
<b>3.3 Fertility Trends and Family</b>	<a href="#">The Contraceptive and Fertility Revolution in India: A Regional Analysis, 1992-2005</a>	Charles Hirschman, Maria Loria Vignau, Xinguang Fan
Session Chair: <a href="#">Abdel-Samad Ali</a>	<a href="#">The Impact of Intergenerational Co-residence on Fertility in East Asia</a>	Poh Lin Tan
Venue: L8, Meeting Suite 802	<a href="#">The Links between Living Arrangements and Fertility in Germany: The Role of Living Apart Together (LAT) on Fertility Intentions and Realized Fertility</a>	Nicoletta Signoretti
	<a href="#">Testing of Convergence Hypothesis to Progress in Contemporary Fertility Trends in Major Socio-Economic Groups of Developing Countries</a>	Srinivas Goli, Swastika Chakravorty
<b>3.4 Marriage in Transition</b>	<a href="#">Paradigms of Commitment in LAT Relationships</a>	Edith Gray, Ann Evans
Session Chair: <a href="#">Chunni Zhang</a>	<a href="#">Marriage in Transition: Social Change and Reformasi in Indonesia</a>	Premchand Dommaraju, JooEan Tan
Venue: L8, Meeting Suite 803	<a href="#">How Does the Internet Change the Educational Gap in Marriage?</a>	Gina Potarca
	<a href="#">How to Find Mr/Ms Right? A Mixed-Methods Study of Mate Preferences and Search Strategies among Online Daters in Shanghai</a>	Yue Qian, Yang Shen
<b>3.5 Migration Perspectives</b>	<a href="#">Global 'Grasshoppers': Migration and Life Course Disjunctures</a>	Susan McDaniel
Session Chair: <a href="#">Eric Fong</a>	<a href="#">Shifting, Synthesizing, Substituting: Understanding the Messiness of Second-generation Identity Negotiations</a>	Kara Somerville, Scott Walsworth
Venue: L8, Meeting Suite 804	<a href="#">Migration Dynamics: Understanding Better Migration Heterogeneity &amp; Migrant Selectivity and Its Implications for Families and Communities</a>	Sara Curran, Kim Korinek
	<a href="#">Measuring the Experiences of International Students</a>	Scott Walsworth, Kara Somerville

<b>3.6 Transition to Adulthood (I)</b>	<a href="#">Coresidence in the Transition to Adulthood. Results of a Cross-Cultural Comparative Analysis with Panel Data from the United States, Germany, Taiwan, China and Japan</a>	Bernhard Nauck, Qiang Ren
Session Chair: <a href="#">Yuying Tong</a>	<a href="#">Family Migration Context and Adolescent Family Formation Expectations</a>	Sarah Hayford, Monica Grant, Jennifer Glick
Venue: L8, Meeting Suite 805	<a href="#">Marriage, Birth, and Family Life among Young Adults in Taiwan</a>	Chin-Chun Yi, Josef (Kuo-Hsun) Ma
	<a href="#">A Portrait of Chinese Youths' Transition to Marriage: Based on Longitudinal Evidence</a>	Xiaorong Gu
<b>Parallel Sessions: 15.40 - 17.00</b>		
<b>Session Title</b>	<b>Paper Title</b>	<b>Authors</b>
<b>4.1 Marriage Markets</b>	<a href="#">Russian Women in the Marriage Markets of China, Japan and Korea</a>	Sergey Ryazantsev, Svetlana Sivoplyasova
Session Chair: <a href="#">Bussarawan Teerawichitchainan</a>	<a href="#">Becoming 'Apni' (One's Own): Demographic Imbalance, Cross-Cultural Families and Belonging in North India</a>	Paro Mishra
Venue: L6, Ballroom 1	<a href="#">A Comparative Study on Gender Dynamics in Cross-Border Marriages between Mainland China and Hong Kong</a>	Tuen Yi Chiu
	<a href="#">Gender Segregation in Marriage Markets and Inter-marriages in India</a>	Swastika Chakravorty, Srinivas Goli
<b>4.2 Education (I)</b>	<a href="#">China's Higher Education Expansion and Transition to a First Skilled Job among College Graduates</a>	Lingxin Hao, Dong Zhang
Session Chair: <a href="#">Louis Chauvel</a>	<a href="#">Field of Study and Labor Market Outcomes in China: Implications for Intergenerational and Gender Stratification</a>	Shu Hu, Wei-Jun Jean Yeung
Venue: L8, Meeting Suite 801		

	<a href="#">No Other Way Out: Self-exclusion among Middle-class in the College Application Process</a>	Yi-Lin Chiang
	<a href="#">Practice, Habitus and Capital: School Mergers in Singapore</a>	Roy Chua
<b>4.3 Sex Preference and Gender Issues</b>	<a href="#">Husband-to-wife Sexual Coercion in Cross-border Marriage: A Power Perspective</a>	Adam Ka-Lok Cheung, Tuen Yi Chiu
Session Chair: <a href="#">Abhijit Visaria</a>	<a href="#">An Economic Framework for Persisting Son Preference: The Role of Intergenerational Solidarity and Institutions for Income Security</a>	Sara Tafuro
Venue: L8, Meeting Suite 802	<a href="#">Gendered Family Building in India: First Two Boys and then a Daughter</a>	Christophe Guilimoto
	<a href="#">Is it a Boy, a Girl or Whatever? Sex Preference for Children in Europe</a>	Ronny König
<b>4.4 Social Engagement and Caregiving in Older Age</b>	<a href="#">The Relationship between Literacy of Aging and Teaching Effectiveness of Older Adult Education Teachers in Taiwan</a>	Li-Hui Lin, Yu-Chien Chang
Session Chair: <a href="#">Thang Leng Leng</a>	<a href="#">"We Connected and Supported by Ourselves Online." An Exploratory Research on Digital Networking Practices and Reciprocal Social Support among Elderly People in Urban China</a>	Ranran He
Venue: L8, Meeting Suite 803	<a href="#">Exploring Potential Linkages between Social Support, Retirement and Subjective Wellbeing among Older Indians: Does it a Challenge to Policy Makers?</a>	Himanshu Chaurasia
<b>4.5 Ethnic Minorities in Asia-Pacific</b>	<a href="#">Demography of Ethnic Minorities in China</a>	Farhat Yusuf
Session Chair: <a href="#">Bonnie Erickson</a>	<a href="#">Racial Revolution: Understanding the Resurgence of Minority Ethnic Identity in Modern China</a>	Andrew Francis-Tan, Zheng Mu
Venue: L8, Meeting Suite 804	<a href="#">Together Forever: Chinese Immigrants, Funeral Rites and Belonging in Australia</a>	Helen Forbes-Mewett, Gil-Soo Han, Wilfred Yang Wang
	<a href="#">Who are Malay in Indonesia</a>	Aris Ananta, Evi Nurvidya Arifin

<b>4.6 Transition to Adulthood (II)</b>	<a href="#">Young Age at First Cohabitation: A Risk Factor of Intimate Partner Violence and High Unwanted Fertility in Uganda</a>	Sasha Frade, Clifford Odimegwu
Session Chair: <a href="#">Yingchun Ji</a>	<a href="#">Typology of Korean Young Adults' Relationships with Parents</a>	Jiyeon Lee, JeenKyoung Lee, Jaerim Lee
Venue: L8, Meeting Suite 805	<a href="#">Parent-child Relationship, Youth Prosociality, and Youth Volunteering</a>	Pildoo Sung
	<a href="#">Saan Tayo Papunta? (Where To Next?) An Exploratory Study on the Perception of Selected Senior High School Students on School-to-Work Transition</a>	Debbie Mariz Manalili
<b>19.00</b>	<b>Conference Dinner</b> <i>Venue: L6, Ballroom 1</i>	

## Day 2: Friday, 18 May 2018

Parallel Sessions: 09.45 - 11.05		
Session Title	Paper Title	Authors
<b>5.1 Changing Family Structures, Caregiving and Family Support in Later Life</b>	<a href="#">Contextualizing the Resourcing of Daily Life: Understanding Caregiving Challenges and Strategies among Low-income Caregivers of Dependent Seniors in Singapore</a>	Leng Leng Thang, Johan Suen
Session Chair: <a href="#">Judith Treas</a>	<a href="#">Spatial Segregation or Integration: The Political Response After 20 Years of Transformation in the Family Living Arrangements of Dependent Seniors in France</a>	Gaymu Joëlle, Garabige Alexandra, Loïc Trabut
Venue: L6, Ballroom 1	<a href="#">Family Relationships and Social Support among Community-dwelling Elders of Sri Lanka</a>	Shyama Ranabahu, Padmasiri Siddhisena, Sarath Amarasinghe, Palitha Amaraweera, Kadija Ali

	<a href="#"><u>Adult Children’s Educational Attainment and the Cognitive Trajectories of Older Parents</u></a>	Yeonjin Lee
<b>5.2 Child Care and Family Dynamics</b>	<a href="#"><u>What We have Learned from Studying Parental Time with Children</u></a>	Sandra Hofferth
Session Chair: <a href="#"><u>Ann Meier</u></a>	<a href="#"><u>Do Economic Resources Play a Role in Bargaining Child Care in Couples? Parental Investment in Cases of Matching and Mismatching Gender Ideologies in Germany</u></a>	Natalie Nitsche, Daniela Grunow
Venue: L8, Meeting Suite 801	<a href="#"><u>Grandparent Childcare in Changing Demography and Care Needs: Mobilisation, Utilisation and Retaining of Family Capital in Intergenerational Families</u></a>	Sally Ka-Wing Lo
	<a href="#"><u>How Do Family Structure and Family Process Matter? A Comparative Study on the Impacts of Military Deployment and Single Parenthood on Children’s Psychological Wellbeing</u></a>	Ruoqing Rachele Wang-Cendejas
<b>5.3 Work, Family Relations, and Public Policy</b>	<a href="#"><u>When HALE meets the ‘Aging Crisis’</u></a>	Stella Quah
Session Chair: <a href="#"><u>Kriti Vikram</u></a>	<a href="#"><u>Does Working Long Hours Cause Marital Dissolution? Evidence from the Reduction in South Korea’s Workweek Standard</u></a>	Erin Hye-Won Kim, Changjun Lee
Venue: L8, Meeting Suite 802	<a href="#"><u>Work-family Policies and Practices in South Africa: Highlights from a Family-responsible Employer Survey</u></a>	Zitha Mokomane
	<a href="#"><u>Love, Distance and a Future Together – Long-distance Relationships between Managing Intimacy, Mobility &amp; Career and Planning the Future</u></a>	Markus Klingel
<b>5.4 Migration and Development</b>	<a href="#"><u>Who Migrates and Who stays? The Heterogeneity Migration on Rural Household Economy in China</u></a>	Yuying Tong, Binbin Shu
Session Chair: <a href="#"><u>Qiang Ren</u></a>	<a href="#"><u>Labor Migration, Family Separation and the Long-term Outcomes of Children: The Case of Northwest China</u></a>	Emily Hannum, Wensong Shen, Li-Chung Hu

Venue: L8, Meeting Suite 803	<a href="#">Beyond a Dichotomy: Parental Involvement among Native and Immigrant Families in Hong Kong</a>	Adam Ka-Lok Cheung, Hyunjoon Park
	<a href="#">A Longitudinal Analysis of Immigrant Earnings: Testing the Impact of Admission Categories</a>	Onoso Imoagene, David Kirui
<b>5.5 Non-normative Families (I)</b>	<a href="#">Deconstructing Disadvantage: Single Motherhood and Mental Health in the United States</a>	Lisa Boyd
Session Chair: <a href="#">Lavanya Balachandran</a>	<a href="#">Same-sex Partnership Registrations at the Municipal Level in Japan</a>	Miwa Sato, Hiroyuki Kubota
Venue: L8, Meeting Suite 804		
<b>5.6 Transition to Adulthood (III)</b>	<a href="#">Delayed Adulthood, Delayed Desistance? New Evidence from 1999-2015</a>	Jake Hays, Sarah Hayford, Frank Furstenberg
Session Chair: <a href="#">Bernhard Nauck</a>	<a href="#">School-to-work Transition and First Marriage in the Caucasus and Central Asia</a>	Michael Gebel
Venue: L8, Meeting Suite 805	<a href="#">Internal Migration, Marriage Timing and Assortative Mating: A Mixed-Method Study in China</a>	Zheng Mu, Wei-Jun Jean Yeung
	<a href="#">Parental Support in the Course of Leaving Home – Evidence from Germany</a>	Michel Herzig, Anne Berngruber
<b>Parallel Sessions: 11.15 - 12.35</b>		
Session Title	Paper Title	Authors
<b>6.1 Women's Employment and Family Life in Asia</b>	<a href="#">Occupational Changes around Childbirth in Japan</a>	Junko Nishimura
	<a href="#">The Rise of Stay-at-home Mothers in Urban China</a>	Felicia Tian, Zheng Mu
Session Chair: <a href="#">Joo Ean Tan</a>	<a href="#">Educated House-wives in India: A Family Demography Analysis</a>	Srinivas Goli, Swastika Chakravorty
Venue: L6, Ballroom 1	<a href="#">Women Balancing Work and Family in South Korea and China: Insights from Qualitative Interviews</a>	Sirin Sung



<b>6.2 Union Dissolution and Remarriage (I)</b>	<a href="#">Family or Individual Matters? Female Status and 300 Years of Divorce in Japan</a>	Satomi Kurosu, Akihiko Kato
Session Chair: <a href="#">Ausra Maslauskaitė</a>  Venue: L8, Meeting Suite 801	<a href="#">Ruling Divorce, Ruling Gender: How Does Gender Affect Court's Judgment on Contested Divorce Cases in China?</a>	Yu Wang, Ya Su
<b>6.3 Physical Functions and Cognitive Function in Later Life</b>	<a href="#">The Scars of the Past? Childhood Health and Health Differentials in Later Life</a>	Jack Lam, Janeen Baxter
Session Chair: <a href="#">Yi Yang</a>  Venue: L8, Meeting Suite 802	<a href="#">Cognition and SES Relationships among the Mid-aged and Elderly: A Comparison of China and Indonesia</a>	Firman Witoelar, John Strauss, Bondan Sikoki
	<a href="#">Layered Environmental Contexts, Physical Disabilities and Cognition among Older Chinese Adults</a>	Pei-Chun Ko
	<a href="#">Social Context of Functioning Limitations and Disabilities in Russia</a>	Alla Ivanova, Elena Zemlyanova
<b>6.4 Marriage Trends (I)</b>	<a href="#">Tracking a Social Transformation: Asian First Marriage Patterns: 1890-2015</a>	Peter Xenos
Session Chair: <a href="#">Edith Gray</a>	<a href="#">Changing Trends of Early Marriage in Nepal</a>	Neeti Aryal Khanal
Venue: L8, Meeting Suite 803	<a href="#">Are Civil Unions the Future of Marriage?</a>	Wilfried Rault
<b>6.5 Non-normative Families (II)</b>	<a href="#">Full-, Half-, and Step-Sibling Relations in Young and Middle Adulthood</a>	Anja Steinbach, Karsten Hank
Session Chair: <a href="#">Lisa Boyd</a>	<a href="#">When Women 'Do' and 'Display' Families: A Sociological Study of Blended Families in Singapore</a>	Lavanya Balachandran
Venue: L8, Meeting Suite 804	<a href="#">Transnational Family Ties and Migrant Incorporation: Borderland Living among Korean Chinese</a>	Shiwei Chen

<b>6.6 New Dynamics and New Data for Families in Shanghai</b>	<a href="#">Aging Lonely or Aging Alone? Correlates of Loneliness in the Older Adults in Shanghai</a>	Fang Yang
Session Chair: <a href="#">Qiushi Feng</a>	<a href="#">Understanding Parenting-style Differences in China: Social and Cultural Influences</a>	Meng Chen
Venue: L8, Meeting Suite 805	<a href="#">Outsourcing Domestic Work and Female Labor Force Participation in Shanghai</a>	Xiaogang Wu
<b>Parallel Sessions: 13.35 - 14.55</b>		
<b>Session Title</b>	<b>Paper Title</b>	<b>Authors</b>
<b>7.1 Population Dynamics and Forecasts</b>	<a href="#">Forecast Households at the County Level: An Application of the ProFamy Extended Cohort-component Method in Six Counties of Southern California, 2010 to 2040</a>	Qiushi Feng, Zhenglian Wang, Simon Choi, Yi Zeng
Session Chair: <a href="#">Ofra Anson</a>	<a href="#">Declining Population and the Community Power in Japan</a>	Fumie Kumagai
Venue: L6, Ballroom 1	<a href="#">The Risks of Dying Out: Recent Demographic Trends in Rural Spain after the Great Recession</a>	Dolores Sánchez-Aguilera
	<a href="#">The Principle of Sustainable Population</a>	Toshihiko Hara
<b>7.2 Education (II)</b>	<a href="#">Preferences, Partners, and Parenthood: Linking Early Fertility Desires, Union Formation Timing, and Achieved Fertility</a>	Natalie Nitsche, Sarah Hayford
Session Chair: <a href="#">Lingxin Hao</a>	<a href="#">The Educational Gap in Extended Social Fertility: A Generalized Approach to Birth Cohort Changes in the Number of Children Among Women in the US and in Germany, Finland, Israel and Taiwan</a>	Louis Chauvel, Anne Hartung, Eyal Bar-Haim
Venue: L8, Meeting Suite 801	<a href="#">Chinese Children's Academic Performance: The Effect of Parents' Communication Pattern and Family Socio-economic Status</a>	Jiashi Feng, Stella Sun, Geck Hong Yeo, Tick Ngee Sim
	<a href="#">"Half of the morning sky": Gender and Educational Achievement among Chinese Adolescents</a>	Xiaorong Gu, Wei-Jun Jean Yeung

<b>7.3 Family Life and Inequality</b>	<a href="#">Towards the Theory of Singlehood</a>	Akiko Yoshida
Session Chair: <a href="#">Lavanya Balachandran</a>	<a href="#">Gender Double Standard on Infidelity in China: Testimony from a Chinese Post-90s' Social Network</a>	Shuangshuang Yang, Yingchun Ji
Venue: L8, Meeting Suite 802	<a href="#">Pregnant Again?: Risk factors for Repeat Teenage Pregnancies in the Philippines</a>	Maria Paz Marquez
	<a href="#">Gender, Social Inequality and Family Life in Mexico</a>	Olga Rojas
<b>7.4 Union Dissolution and Remarriage (II)</b>	<a href="#">Gender and Re-partnering after Divorce in Four Central European and Baltic Countries</a>	Ausra Maslauskaitė
Session Chair: <a href="#">Premchand Dommaraju</a>	<a href="#">Muslim Marriage Education in Malaysia and Singapore: Accommodating Modernity, Managing Crises, Perfecting the Family?</a>	Maznah Mohamad, Suriani Suratman
Venue: L8, Meeting Suite 803	<a href="#">She is the Dumper, He is the Dumper: How Money, Work, Norms, and Love affect Wives' and Husbands' Initiation of Divorce</a>	Ya Su
	<a href="#">Are Children of a Divorced, Single-parent Family Relatively Disadvantaged? New Evidence from the China Family Panel Studies</a>	Chunni Zhang
<b>7.5 Coping with Retirement</b>	<a href="#">No Spouse, No Son, No Daughter, No Kin in Contemporary China: Differences in Health, Wealth, and Economic Support</a>	Zhangjun Zhou, Ashton Verdery, Rachel Margolis
Session Chair: <a href="#">Pei-Chun Ko</a>	<a href="#">Neighborhood, Social Engagement, and the Elderly's Depression in Shanghai</a>	Jia Miao, Xiaogang Wu
Venue: L8, Meeting Suite 804	<a href="#">Financial Literacy and Psychological Factors on Korean Babyboomers' Retirement Preparation</a>	Jinho Cho
	<a href="#">Friends without Names: Social Networks among Senior Pokemon Go Players in Hong Kong</a>	Ka Yi Fung, Gina Lai
<b>7.6 State, Family and Population (I)</b>	<a href="#">Educational Externalities within the Family: Evidence from School Entry Laws</a>	Poh Lin Tan, Emma Zang, Philip Cook

Session Chair: <a href="#">Ern Ser Tan</a>	<a href="#">Family-supportive Workplace Policy Accessibility and its Determinants in South Korea</a>	Eun Jung Kim
Venue: L8, Meeting Suite 805	<a href="#">Longitudinal Impact of Food Supplementation Program in Early Childhood on Academic Achievement among Children in India: Evaluating the Integrated Child Development Scheme</a>	Kriti Vikram
	<a href="#">Career Contingency of Married Women in Korea</a>	Hyunjin Kim
<b>14.55 – 15.25</b>	<b>Meet the Editors Session for Asian Population Studies</b>	<i>L6, Ballroom 2 Routledge Booth</i>
<b>Parallel Sessions: 15.25 - 16.40</b>		
<b>Session Title</b>	<b>Paper Title</b>	<b>Authors</b>
<b>8.1 Child Care and Child Development</b>  Session Chair: <a href="#">Xiaorong Gu</a>  Venue: L6, Ballroom 1	<a href="#">Maternal Employment, Grandparental Proximity, and Children's Well-being</a>	James Raymo, Jia Wang
	<a href="#">The 'Developmental Gradient' Revisited: Australian Children's Time with Adult Caregivers from Infancy to Adolescence</a>	Martin O'Flaherty, Janeen Baxter
	<a href="#">Residential Context Deprivation and Personality Traits. Associations with Adolescent Problem Behaviour and Educational Attainment</a>	Jaap Nieuwenhuis
	<a href="#">Parenting Under Pressure: A Systematic Review on Child Caring Problems in Asian Urban Poor Context</a>	Rachma Nurbani
<b>8.2 Intergenerational Dynamics</b>  Session Chair: <a href="#">Charles Hirschman</a>  Venue: L8, Meeting Suite 801	<a href="#">Determinants of Intergenerational Living Arrangements in Japan: A Comparison between Living Together, Living Nearby, and Living Far Away with the Husband's and the Wife's Parents</a>	Reiko Yamato
	<a href="#">Patterns and Determinants of Japanese "Sandwich" Generations' Support to Elderly Parents</a>	Nobutaka Fukuda
	<a href="#">Bringing Grandparents back in: Impact of Parents' Social Economic Status, Health and Living Arrangement on Reproductive Behaviors of their Adult Children</a>	Li-Hsuan Cheng

	<a href="#">Growing up with Immigrant Parents: Perspectives of Second Generation South Asian Canadians</a>	Kara Somerville, Scott Walsworth
<b>8.3 Health and Family</b>	<a href="#">Population and Health of the Indigenous People in Australia</a>	Farhat Yusuf, Stephen Leeder
Session Chair: <a href="#">Yeonjin Lee</a>	<a href="#">Wife Breadwinning and Implications for Husband's and Wife's Health: A Life Course and Cohort Approach</a>	Wen Fan
Venue: L8, Meeting Suite 802	<a href="#">Phenomena under-Five Stunting Children in Indonesia: Binary Multilevel Regression Analysis on Individual, Household and Regional Level</a>	Titik Harsanti, Febri Wicaksono
	<a href="#">Sharing Cancer Genetic Results among Family Members in Singapore</a>	Shao-Tzu Li, Shirley Sun, Désirée Lie, Marie Met-Domestici, Eliza Courtney, Sapna Menon, Geok Hoon Lim, Joanne Ngeow
<b>8.4 Marriage Trends (II)</b>	<a href="#">Socioeconomic Assortative Mating and Village Exogamy in Mid-20th Century China: Evidence from Archival Microdata</a>	Cameron Campbell, Xiangning Li, Matthew Noellert, James Lee
Session Chair: <a href="#">Yue Qian</a>	<a href="#">Payment for Marriage: Bride Price and Dowry in Rural China</a>	Li-Chung Hu
Venue: L8, Meeting Suite 803	<a href="#">Marriage Indebted: Student Debt, Union Formation, and Repayment</a>	Jung In
	<a href="#">Understanding the Dynamics between Education and Family: An Emergence of Market-based Educational Enterprise</a>	Achala Gupta
<b>8.5 Aging and Beyond</b>	<a href="#">Sex Differences in Genetic Associations with Longevity in Han Chinese: Sex-stratified Genome-wide Association Study and Polygenic Risk Score</a>	Yi Zeng, Huashuai Chen, Xiaomin Liu, Rui Ye
Session Chair: <a href="#">Abhijit Visaria</a>	<a href="#">Language and Living Arrangements: Pathways to Linguistic Isolation among Older Immigrants in the U.S.</a>	Zoya Guberskaya, Judith Treas
Venue: L8, Meeting Suite 804	<a href="#">Nature and Prevalence of Elderly Abuse in Kano Municipal Local Government Area of Kano State, Nigeria</a>	Mohammed Mustapha Namadi

	<a href="#">Characterizing Long-Term Care (LTC) Needs and Unmet Needs among Chinese Elderly - Findings from the 2002-2008/09 CLHLS</a>	Yi Yang
<b>8.6 Data and Methods</b>	<a href="#">On Equality and Inequality in Stationary Populations</a>	David Swanson, Lucky Tedrow
Session Chair: <a href="#">Vincent Chua</a>	<a href="#">Generalized Inflated Discrete Models: A Strategy to Work with Multimodal Discrete Distributions</a>	Tianji Cai, Yiwei Xia, Yisu Zhou
Venue: L8, Meeting Suite 805	<a href="#">Does the Household-based Census Capture the Diversity of Family Configurations (in France)</a>	Loïc Trabut, Eva Lelièvre
	<a href="#">Using Twitter Detects Teenagers' Behavior on E-cigarette: A Spatio-Temporal and Machine Learning Approach</a>	Jiaqi Tang, Shuya Lu, Leyi Hu, Siyu Chen

### Day 3: Saturday, 19 May 2018

Parallel Sessions: 08.30 - 09.50		
Session Title	Paper Title	Authors
<b>9.1 Time Use and Quality of Life</b>	<a href="#">Quality of Life and Care Before Death of Elderly in China</a>	Zhenzhen Zheng, Yun Zhou
Session Chair: <a href="#">Akiko Yoshida</a>	<a href="#">"Me Time" and "We Time": Parents' Leisure Quality with and without Children</a>	Ann Meier, Kelly Musick, Sarah Flood
Venue: L6, Ballroom 1	<a href="#">The Relationship between Welfare Regimes and Actual Family Life: A Comparative Study Using ISSP2012</a>	Kota Toma
	<a href="#">Cross-spouse Influence of Education on Men's and Women's Time Use in Spain</a>	Marco Antonio Faytong Haro
<b>9.2 Gender and Child Development</b>	<a href="#">The Social Stratification of Sex Differences in Child Development</a>	Ibrahim Demirer, Markus Klein, Michael Kühhirt
Session Chair: <a href="#">James Raymo</a>	<a href="#">Gendered Competition among Chinese Adolescents: From a Competitive Education System and Harmonious Culture</a>	Erzhen Hu, Yingchun Ji

Venue: L8, Meeting Suite 801	<a href="#">Changing Aspiration of Shanghai Parents for their Daughters: A Conservative Turn</a>	Ying Zhu, Yingchun Ji
	<a href="#">Tween Girls' Dressing in Singapore: Aspirations, Allowances and Affiliations</a>	Bernice Loh
<b>9.3 Historical Demography</b>	<a href="#">The China Multigenerational Panel Databases (CMGPD): A Source for the Study of Family, Population, and Stratification</a>	Cameron Campbell, James Lee
Session Chair: <a href="#">Peter Xenos</a>	<a href="#">France is Expecting its Third Child: The Debate in the Media on the Return of "Denatalité" (1974-1979) and its Effects</a>	Virginie De Luca Barrusse
Venue: L8, Meeting Suite 802	<a href="#">Household Hierarchy and Household Division in Northeast China, 1789-1909</a>	Xiangning Li
	<a href="#">Did Historical Tuberculosis Sanatoriums Select between Multiple Long-run Equilibria? The Spatial Distribution of Economic Activity in Germany</a>	Philipp Jaschke, Sebastian Till Braun, Carola Braun
<b>9.4 Marriage and Family Life</b>	<a href="#">Live (in) and Let Live: Cohabitation and Marriage among Young Unmarried Couples in the Philippines</a>	Narciso Jr. Aguid, Gwynette Depot, Carl Johnson Anacin
Session Chair: <a href="#">Maznah Mohamad</a>	<a href="#">Life of Inter-caste Married Couples: An Investigation into the Life Trajectories During the Starting Years of their Marital Life</a>	Shalini Meshram, Abdul Jaleel
Venue: L8, Meeting Suite 803	<a href="#">Family Formation of South African Women in the Era of Family Change</a>	Nompumelelo Nzimande
	<a href="#">Social Engagement and Psychological Well-being: Findings from the PINE Study</a>	Wei Zhang, Lin Liu, Fengyan Tang, Xinqi Dong
<b>9.5 Sexuality and Reproductive Health (II)</b>	<a href="#">A Decade of Intra-household Dynamics on the Contraceptive Use Decision: Results from the Indonesia Family Life Survey</a>	Ni Wayan Suriastini, Evita Hanie Pangaribowo, Kusmaintan Widya Lestari, NS Arnashanti
Session Chair: <a href="#">Sarah Hayford</a>	<a href="#">Critical Appraisal of Community Interventions: A Study of Family Planning Programs in Bangladesh</a>	Bhanu Bhatia
Venue: L8, Meeting Suite 804	<a href="#">Medically Necessary? Place of Delivery and the Odds of Caesarean Section in Pakistan</a>	Cynthia Cready, Saman Nazir

	<a href="#"><u>Exploring Community Perception and Attitudes Towards Adolescent Friendly Health Program in Nepal</u></a>	Pushpa Lata Pandey, Husna Raze, Holly Seale
<b>9.6 State, Family and Population (II)</b>	<a href="#"><u>The Effect of a Reduced Statutory Workweek on Familial Long-term Care in Korea</u></a>	Erin Hye-Won Kim, Changjun Lee, Young Kyung Do
Session Chair: <a href="#"><u>Poh Lin Tan</u></a>	<a href="#"><u>Gender Dimensions of and Challenges in Local Health Legislation</u></a>	Ann Heather Kiwang
Venue: L8, Meeting Suite 805	<a href="#"><u>Large Family, Poor Family?: A Comparative Child-Centered Analysis of the Modern Large Family and Implications for Social Policy</u></a>	Megan Curran
<b>10.20 - 12.00nn</b>	<b>Plenary Session on Family Changes in Asia</b> <i>Venue: L6, Ballroom 1</i>	
<b>Farewell Tea &amp; Closing of the Conference</b>		



# ADMINISTRATIVE INFORMATION

## ***Conference Materials***

A programme booklet, pen and a nametag will be provided to all conference participants upon registration. The nametag must be worn at all times during the conference.

## ***Internet connection***

Login: Wireless@Mandarin Orchard

Click: 'Visitor' Guest

Password: nus2018

## ***Transportation from Conference Designated Hotels to Mandarin Orchard Singapore***

Village Hotel Albert Court is providing free transport services for guests staying at its hotel. Guests staying at Park Avenue Rochester and Dorsett Hotel Singapore should check with their hotel reception regarding the possibility of free transport to the conference venue.

### *Pick-up time (Route: Hotel → Mandarin Orchard Singapore)*

<b>Hotel</b>	<b>Day 1</b>	<b>Day 2</b>	<b>Day 3</b>
Village Hotel Albert Court	7.30am	7.35am	7.30am
Park Avenue Rochester	Please check with hotel		
Dorsett	Please check with hotel		

## ***Conference Dinner***

The conference dinner is scheduled on Thursday, 17 May. Venue is at Mandarin Orchard Singapore, Main Tower, Level 6, Ballroom 1. Please bring along your nametags for entry. There will be cultural performances during the dinner from 7.30pm.

## ***Nearby Mosque from Mandarin Orchard Singapore***

Masjid Al-Falah (3-minute walk): 22 Bideford Road, #01-01, Singapore 229923

# USEFUL INFORMATION ABOUT SINGAPORE

## **Public Transport**

Singapore is well connected with commuters able to choose between trains, taxis and buses. You can purchase stored-value fare cards (EZLINK) which can be used for bus, train and cab rides.

For taxis, you may place advanced bookings through these numbers:

Comfort CityCab	(65) 6552 1111
Comfort Premier Cabs	(65) 6552 2828
SMRT Taxis	(65) 6555 8888
Premier Taxis	(65) 6363 6888

You may pay with cash, credit card, NETS, or CEPAS stored-value cards, subject to the availability of such payment devices in the taxis. Cashless payment charges may apply.

**TIP:** Always ask the taxi driver at the beginning of the journey if you have any queries about the mode of payment, or if they have change for a big note.

Please visit the LTA website to know more about the Singapore public transport system including hours of operation for train and bus networks.

LTA website: <http://www.lta.gov.sg/content/ltaweb/en.html>

## **Public Transport Directions to Mandarin Orchard Singapore**

Visitors can get to Mandarin Orchard Singapore by the following modes of transport.

### Taxi

Mandarin Orchard is located at 333 Orchard Road Singapore. Postal code: 238867

### MRT

From Somerset MRT Station – 5-minute walk

From Orchard MRT Station – 10-minute walk

Mandarin Orchard Singapore website: <http://www.meritushotels.com/en/mandarin-orchard-singapore/contact-us.html>

## **Emergency numbers**

999 - Police Emergency | 995 - Fire | 1777 - Non-emergency ambulance

# AUTHOR INDEX

## Author Name...Panel No.

Agadjanian, Victor..... 2.4  
Aguid, Narciso Jr..... 9.4  
Ajang, Fajar ..... 1.4  
Akinyemi, Joshua ..... 1.6  
Ali, Abdel-Samad M..... 2.3  
Ali, Kadija ..... 5.1  
Amarasinghe, Sarath ..... 5.1  
Amaraweera, Palitha ..... 5.1  
Anacin, Carl Johnson ..... 9.4  
Ananta, Aris ..... 4.5  
Ang, Shannon ..... 1.2  
Anilkumar Hemalatha, Sruthi ..... 1.1  
Arifin, Evi Nurvidya ..... 2.6, 4.5  
Arnashanti, NS ..... 9.5  
Arsi, Antari Ayuning ..... 1.4  
Aryal Khanal, Neeti ..... 6.4  
Balachandran, Lavanya ..... 6.5  
Bar-Haim, Eyal ..... 7.2  
Bask, Miia ..... 2.2  
Baxter, Janeen ..... 6.3, 8.1  
Berngruber, Anne ..... 5.6  
Bhatia, Bhanu ..... 9.5  
Bhuyan, Bibhishana ..... 1.5  
Billingsley, Sunnee ..... 1.6  
Boyd, Lisa ..... 5.5  
Braun, Carola ..... 9.3  
Braun, Sebastian Till ..... 9.3  
Cai, Tianji ..... 8.6  
Campbell, Cameron ..... 8.4, 9.3  
Chakravorty, Swastika ..... 3.3, 4.1, 6.1  
Chan, Angelique ..... 2.6

## Author Name...Panel No.

Chang, Yu-Chien ..... 4.4  
Chaurasia, Himanshu ..... 4.4  
Chauvel, Louis ..... 7.2  
Chen, Huashuai ..... 8.5  
Chen, Meng ..... 6.6  
Chen, Shiwei ..... 6.5  
Chen, Siyu ..... 8.6  
Chen, Xuejiao ..... 3.2  
Cheng, Li-Hsuan ..... 8.2  
Cheung, Adam Ka-Lok ..... 4.3, 5.4  
Chiang, Yi-Lin ..... 4.2  
Chiu, Tuen Yi ..... 4.1, 4.3  
Cho, Jinho ..... 7.5  
Choi, Simon ..... 7.1  
Chua, Roy ..... 4.2  
Chua, Vincent ..... 2.1  
Cook, Philip ..... 7.6  
Courtney, Eliza ..... 8.3  
Cready, Cynthia ..... 9.5  
Curran, Megan ..... 9.6  
Curran, Sara ..... 3.5  
Dagistanli, Selda ..... 1.3  
Das, Kailash Chandra ..... 1.5  
Dato, Christine Danne ..... 1.4  
David, Beata ..... 2.1  
De Luca Barrusse, Virginie ..... 9.3  
De Wet, Nicole ..... 1.6  
Demirer, Ibrahim ..... 9.2  
Depot, Gwynette ..... 9.4  
Ding, Hua ..... 3.1  
Do, Young Kyung ..... 9.6

Dommaraju, Premchand ..... 3.4  
 Dong, Xinqi ..... 9.4  
 Erickson, Bonnie H. .... 2.1  
 Evans, Ann ..... 3.4  
 Fan, Wen ..... 8.3  
 Fan, Xinguang ..... 3.3  
 Fang, Lue ..... 3.2  
 Faytong Haro, Marco Antonio..... 9.1  
 Feng, Jiashi ..... 7.2  
 Feng, Qiushi ..... 7.1  
 Flood, Sarah ..... 9.1  
 Fong, Eric ..... 2.5  
 Forbes-Mewett, Helen ..... 4.5  
 Frade, Sasha ..... 1.6, 4.6  
 Francis-Tan, Andrew ..... 4.5  
 Fukuda, Nobutaka ..... 8.2  
 Fung, Ka Yi ..... 7.5  
 Furstenberg, Frank ..... 1.1, 5.6  
 Garabige, Alexandra ..... 5.1  
 Gebel, Michael ..... 2.3, 5.6  
 Gissler, Mika ..... 2.2  
 Glick, Jennifer ..... 3.6  
 Goli, Srinivas ..... 3.3, 4.1, 6.1  
 Grant, Monica ..... 3.6  
 Gray, Edith ..... 3.4  
 Grunow, Daniela ..... 5.2  
 Gu, Xiaorong ..... 3.6, 7.2  
 Guberskaya, Zoya ..... 8.5  
 Guilimoto, Christophe ..... 4.3  
 Gupta, Achala ..... 8.4  
 Haapakorva, Pasi ..... 2.2  
 Han, Gil-Soo ..... 4.5  
 Hanie Pangaribowo, Evita ..... 9.5  
 Hank, Karsten ..... 6.5  
 Hannum, Emily ..... 5.4  
 Hao, Lingxin ..... 4.2  
 Hara, Toshihiko ..... 7.1  
 Harsanti, Titik ..... 8.3  
 Hartung, Anne ..... 7.2  
 Hayford, Sarah ..... 2.4, 3.6, 5.6, 7.2  
 Hays, Jake ..... 5.6  
 He, Ranran ..... 4.4  
 Herzig, Michel ..... 5.6  
 Himoldang, Jhun ..... 1.5  
 Hirschman, Charles ..... 3.3  
 Hofferth, Sandra ..... 5.2  
 Hu, Erzhen ..... 9.2  
 Hu, Leyi ..... 8.6  
 Hu, Li-Chung ..... 5.4, 8.4  
 Hu, Shu ..... 4.2  
 Huang, Peng ..... 1.5  
 Huppertz, Kate ..... 1.3  
 Imoagene, Onoso ..... 5.4  
 In, Jung ..... 8.4  
 Ivanova, Alla ..... 6.3  
 Jaleel, Abdul ..... 9.4  
 Jang, Jinhee ..... 1.1  
 Jansen, Natalie ..... 2.4  
 Jaschke, Philipp ..... 9.3  
 Ji, Yingchun ..... 2.3, 7.3, 9.2  
 Joëlle, Gaymu ..... 5.1  
 Johnson, Lauren ..... 1.2  
 Karunarathne, Migara ..... 1.6  
 Kato, Akihiko ..... 6.2  
 Kim, Erin Hye-Won ..... 5.3, 9.6  
 Kim, Eun Jung ..... 7.6  
 Kim, Hyunjin ..... 7.6  
 Kim, Ji Hye ..... 1.3

Kim, Young Jeong ..... 1.1  
 Kirui, David ..... 5.4  
 Kiwang, Ann Heather ..... 9.6  
 Klein, Markus ..... 9.2  
 Klingel, Markus ..... 1.2, 5.3  
 Knodel, John ..... 3.2  
 Ko, Pei-Chun ..... 1.4, 6.3  
 Koh, Gillian ..... 2.1  
 Kong, Tao ..... 3.1  
 König, Ronny ..... 4.3  
 Korinek, Kim ..... 3.5  
 Kubota, Hiroyuki ..... 5.5  
 Kühhirt, Michael ..... 9.2  
 Kumagai, Fumie ..... 7.1  
 Kurosu, Satomi ..... 6.2  
 Lai, Gina ..... 7.5  
 Lai, Weiwen ..... 2.4  
 Lam, Jack ..... 6.3  
 Lamas Abraira, Laura ..... 3.2  
 Lanari, Donatella ..... 1.1  
 Lee, Changjun ..... 5.3, 9.6  
 Lee, Jaerim ..... 4.6  
 Lee, James ..... 8.4, 9.3  
 Lee, JeenKyoung ..... 4.6  
 Lee, Jiyeon ..... 4.6  
 Lee, Yeonjin ..... 1.4, 2.6, 5.1  
 Leeder, Stephen ..... 8.3  
 Lelièvre, Eva ..... 8.6  
 Lestari, Kusmaintan Widya ..... 9.5  
 Li, Jenny Xin ..... 1.4  
 Li, Shao-Tzu ..... 8.3  
 Li, Xiangning ..... 8.4, 9.3  
 Lie, Désirée ..... 8.3  
 Lim, Geok Hoon ..... 8.3  
 Lin, Li-Hui ..... 4.4  
 Liu, Lin ..... 9.4  
 Liu, Sizhe ..... 1.5  
 Liu, Xiaomin ..... 8.5  
 Liu, Yue ..... 2.3  
 Lo, Sally Ka-Wing ..... 5.2  
 Loh, Bernice ..... 9.2  
 Loria Vignau, Maria ..... 3.3  
 Löwe, Paul Severin ..... 2.3  
 Lu, Shuya ..... 8.6  
 Lukács, Agnes ..... 2.1  
 Luthfi, Asma ..... 2.2  
 Ma, Josef (Kuo-Hsun) ..... 3.6  
 Mahapatro, Sandhya ..... 2.5  
 Malhotra, Rahul ..... 2.6  
 Manalili, Debbie Mariz ..... 4.6  
 Margolis, Rachel ..... 7.5  
 Marquez, Maria Paz ..... 4.3, 7.3  
 Maslauskaitė, Ausra ..... 7.4  
 Matsuda, Shigeki ..... 1.3  
 May-Ling Lee, June ..... 2.6  
 McDaniel, Susan ..... 3.5  
 Meier, Ann ..... 9.1  
 Menon, Sapna ..... 8.3  
 Meshram, Shalini ..... 9.4  
 Met-Domestici, Marie ..... 8.3  
 Miao, Jia ..... 7.5  
 Mishra, Paro ..... 4.1  
 Mohamad, Maznah ..... 7.4  
 Mokomane, Zitha ..... 5.3  
 Mu, Zheng ..... 4.5, 5.6, 6.1  
 Musa, Awatif ..... 2.2  
 Musick, Kelly ..... 9.1  
 Namadi, Mohammed Mustapha ..... 8.5

Nauck, Bernhard ..... 3.6  
 Nazir, Saman ..... 9.5  
 Ngeow, Joanne ..... 8.3  
 Nguyen, Trung Kien ..... 2.1  
 Nieuwenhuis, Jaap ..... 8.1  
 Nishimura, Junko ..... 6.1  
 Nitsche, Natalie ..... 5.2, 7.2  
 Noellert, Matthew ..... 8.4  
 Noonan, Mary ..... 1.3  
 Nuraini, Syarifah ..... 2.6  
 Nurbani, Rachma ... 8.1  
 Nzimande, Nompumelelo ..... 9.4  
 Odimegwu, Clifford ..... 1.6, 4.6  
 O'Flaherty, Martin ..... 8.1  
 Pandey, Pushpa Lata ..... 9.5  
 Park, Hyunjoon ..... 5.4  
 Pasqualini, Marta ..... 1.1  
 Pieroni, Luca ..... 1.1  
 Piotrowski, Martin ..... 1.2  
 Potarca, Gina ..... 3.4  
 Qian, Yue ..... 3.4  
 Quah, Stella ..... 5.3  
 Ranabahu, Shyama ..... 5.1  
 Rault, Wilfried ..... 6.4  
 Raymo, James ..... 8.1  
 Razee, Husna ..... 9.5  
 Ren, Qiang ..... 1.5, 3.6  
 Ristikari, Tiina ..... 2.2  
 Rojas, Olga ..... 7.3  
 Rothwell, David ..... 2.2  
 Ryazantsev, Sergey ..... 4.1  
 Sanchez, Constantino Narciso ..... 1.4  
 Sánchez-Aguilera, Dolores ..... 7.1  
 Sastry, Narayan ..... 3.1  
 Sato, Miwa ..... 5.5  
 Seale, Holly ..... 9.5  
 Senda, Yukiko ..... 2.3  
 Shen, Wensong ..... 5.4  
 Shen, Yang ..... 3.4  
 Shibuya, Kumiko ..... 2.5  
 Shu, Binbin ..... 1.4, 2.4, 5.4  
 Siddhisena, Padmasiri ..... 5.1  
 Signoretti, Nicoletta ..... 3.3  
 Sikoki, Bondan ..... 1.2, 6.3  
 Sim, Tick Ngee ..... 7.2  
 Sivoplyasova, Svetlana ..... 4.1  
 Somerville, Kara ..... 3.5, 8.2  
 Song, Jing ..... 2.4  
 Soy, Nelson Franklin ..... 1.1  
 Steinbach, Anja ..... 6.5  
 Strauss, John ..... 1.2, 6.3  
 Su, Ya ..... 6.2, 7.4  
 Suen, Johan ..... 5.1  
 Sun, Shirley ..... 8.3  
 Sun, Stella ..... 7.2  
 Sung, Pildoo ..... 4.6  
 Sung, Sirin ..... 6.1  
 Suratman, Suriani ..... 7.4  
 Suriastini, Ni Wayan ..... 9.5  
 Svallfors, Signe ..... 1.6  
 Swanson, David ..... 8.6  
 Tan, Ern Ser ..... 2.1  
 Tan, Harry ..... 2.6  
 Tan, JooEan ..... 3.4  
 Tan, Poh Lin ..... 3.3, 7.6  
 Tang, Fengyan ..... 9.4  
 Tang, Jiaqi ..... 8.6  
 Tedrow, Lucky ..... 8.6

Teerawichitchainan, Bussarawan ..... 3.2  
 Thang, Leng Leng ..... 5.1  
 Tian, Felicia ..... 6.1  
 Toma, Kota ..... 9.1  
 Tong, Yuying ..... 1.4, 5.4  
 Trabut, Loïc ..... 4.4, 5.1, 8.6  
 Treas, Judith ..... 8.5  
 Verdery, Ashton ..... 7.5  
 Vikram, Kriti ..... 2.4, 7.6  
 Visaria, Abhijit ..... 2.6  
 Walsworth, Scott ..... 3.5, 8.2  
 Wang, Huiguang ..... 2.3  
 Wang, Jia ..... 8.1  
 Wang, Yu ..... 6.2  
 Wang, Zhenglian ..... 7.1  
 Wang-Cendejas, Ruoqing Rachele ..... 5.2  
 Weon, Soyeon ..... 2.2  
 Wicaksono, Febri ..... 8.3  
 Wicaksono, Harto..... 1.4  
 Witoelar, Firman ..... 1.2, 6.3  
 Wolford, Rick ..... 1.2  
 Wu, Qiong ..... 1.5  
 Wu, Xiaogang ..... 6.6, 7.5  
 Xenos, Peter ..... 6.4  
 Xia, Yiwei ..... 8.6  
 Xu, Ruonan ..... 2.3  
 Yamato, Reiko ..... 8.2  
 Yang Wang, Wilfred ..... 4.5  
 Yang, Fang ..... 6.6  
 Yang, Shuangshuang ..... 7.3  
 Yang, Yi ..... 2.5, 8.5  
 Ye, Rui ..... 8.5  
 Yeo, Geck Hong ..... 7.2  
 Yeung, Wei-Jun Jean ..... 2.6, 4.2, 5.6, 7.2  
 Yi, Chin-Chun ..... 3.6  
 Yoshida, Akiko ..... 1.2, 7.3  
 Yusuf, Farhat ..... 4.5, 8.3  
 Zang, Emma ..... 7.6  
 Zemlyanova, Elena ..... 6.3  
 Zeng, Yi ..... 7.1, 8.5  
 Zhang, Chunni ..... 1.5, 7.4  
 Zhang, Dong ..... 4.2  
 Zhang, Wei ..... 1.5, 9.4  
 Zheng, Zhenzhen ..... 9.1  
 Zhou, Yisu ..... 8.6  
 Zhou, Yun ..... 9.1  
 Zhou, Zhangjun ..... 7.5  
 Zhu, Ying ..... 9.2

## Vision

To provide leadership for family and  
population research

## Mission

- Promote cutting-edge, empirically-based and policy-relevant research
- Provide trainings in social science research
- Foster collaborations among academics and policy makers

Ventus (University Campus Infrastructure), Unit #03-01  
8 Kent Ridge Drive, Singapore 119246

 [cfpr@nus.edu.sg](mailto:cfpr@nus.edu.sg)

 <http://www.fas.nus.edu.sg/cfpr/>

   @nuscfpr